

3" Rapid Z™ Replacement Drum INSTRUCTION MANUAL

DW3-C & DW3-F



Scan QR Code to see resources and videos regarding the Rapid Z™ items or visit us at [nsisolutions.com](https://www.nsisolutions.com) or YouTube channel **NSITools**.



Read and Understand All Instructions

Failure to follow all instructions listed below may result in electric shock, fire, and/or serious personal injury. Additionally, observe all safety instructions provided with the electric and air tools.



Use Proper Safety Gear

To prevent damage to eyes from flying debris, wear protective glasses or face shield. Be sure to wear waterproof safety boots, appropriate hearing protection and dust protection as required.



Inspect Before Use

Before each use, inspect the Rapid Z™-DRUM for damage. Never use a Rapid Z™-DRUM that has damaged components.



Wet Use Only

The Rapid Z™-DRUM is designed for wet use only.



Observe Maximum RPM

Maximum RPM 8500



Caution

Always be sure that the grinder is switched off and unplugged from power (either electric or air) before installing/removing the Rapid Z™-DRUM or attempting to perform any inspection or maintenance.

TOOLS NEEDED FOR ASSEMBLY/DISASSEMBLY

- 5/16" Allen (hex) wrench
- Vise

REPLACEMENT INSTRUCTIONS

1. Replace the grinding drum as follows:
 - a. Clamp the Rapid Z™-DRUM upside down in a vise.
 - b. Using a 5/16 Allen wrench remove the socket head cap screw, washer and cap from the arbor.

- c. Remove the old drum. Make sure the key remains in place
 - d. Install the new drum onto the arbor with side "1" visible.
 - e. Reinstall the cap, washer and socket head cap screw and tighten.
2. As the diamonds begin to dull grinding will become harder. At this point the drum can be flipped to extend its life using the process outlined in step 1 above. When side 2 is dull the drum should be replaced.

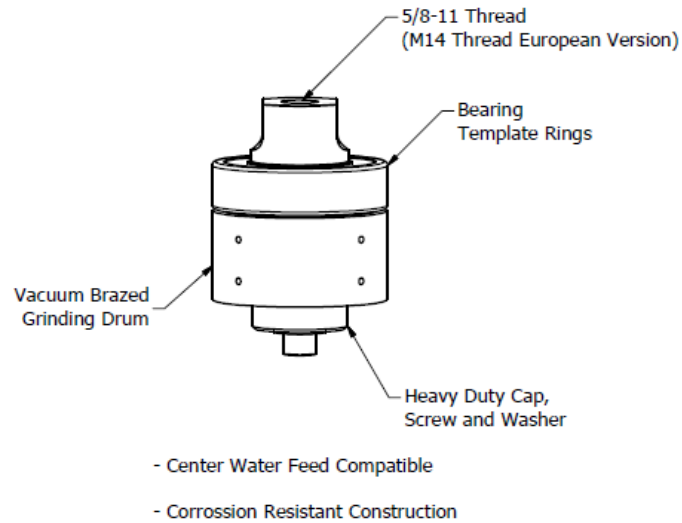

FIGURE 1 – 3” Rapid Z™-Drum with Template Bearing (Assembled)

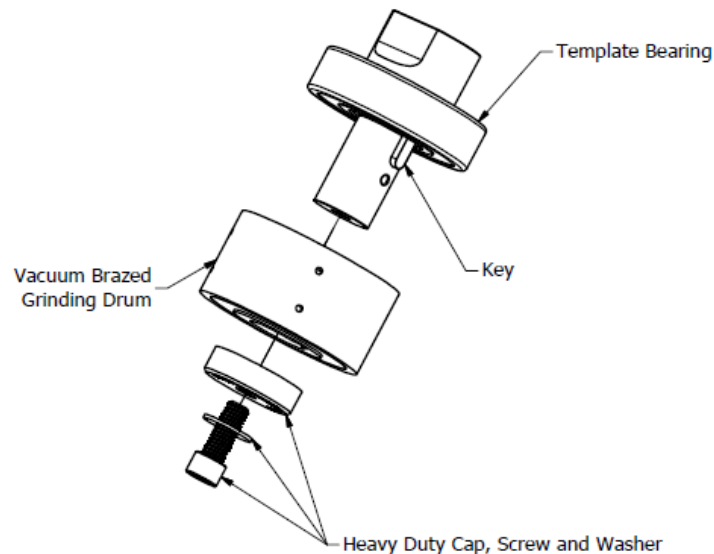

FIGURE 2 – 3” Rapid Z™-DRUM with Template Bearing (Exploded)

All Rapid Z™ Products are Proudly Designed & Assembled in the U.S.A. from Global Components