

3" Rapid Z™-CUT (No Bearing) INSTRUCTION MANUAL

Z-CUT

INTRODUCCION

Thank you for purchasing the NSI Solutions Rapid Z™-CUT. The Rapid Z™-CUT is a 3", stacked blade type, grinding wheel designed to quickly grind stone and quartz. This version, without a top bearing, is designed to be used for free hand shaping or anywhere a template bearing is not required. Please read these instructions thoroughly before using this tool. Keep these instructions in a place where operators can access it easily.



Scan QR Code to see resources and videos regarding the Rapid Z™ items or visit us at [nsisolutions.com](https://www.nsisolutions.com) or YouTube channel **NSITools**.



Read and Understand All Instructions

Failure to follow all instructions listed below may result in electric shock, fire, and/or serious personal injury. Additionally, observe all safety instructions provided with the electric and air tools.



Use Proper Safety Gear

To prevent damage to eyes from flying debris, wear protective glasses or face shield. Be sure to wear waterproof safety boots, appropriate hearing protection and dust protection as required.



Inspect before Use

Before each use, inspect the Rapid Z™-CUT for bent, cracked or otherwise damaged blades. Replace damaged blades before use. Never use a Rapid Z™-CUT with damaged blades or other components.



Wet Use Only

The Rapid Z™-CUT is designed for wet use only



Observe maximum RPM

Maximum RPM 12,000



Caution

Always be sure that the grinder is switched off and unplugged from power (either electric or air) before installing/removing the Rapid Z™-CUT or attempting to perform any inspection or maintenance.

TOOLS NEEDED FOR ASSEMBLY/DISASSEMBLY

- 5/16" Allen (Hex) wrench
- Vise

INSTRUCTIONS

1. The Rapid Z™-CUT is designed for clockwise rotation, looking down on the threaded arbor mounting hole, and should not be used on a grinder or tool with the opposite rotation.
2. The Rapid Z™-CUT mounts to a male 5/8-11 thread (M14 thread on European version). Prior to use, ensure it is mounted tightly.
3. The Rapid Z™-CUT is designed for wet use only. Use either center water feed or a sufficient external water spray. Ensure enough water is used to avoid creating dust.
4. As the blades wear they will create an "apple core" shape. For maximum blade life the blades should be rearranged often. Relocate the largest blades (normally the outer blades) to a location where they will get more wear (normally toward the center of the stack). This can be accomplished as follows (see Figure 1 & 2):
 - a. Clamp the Rapid Z™-CUT upside down in a vise.
 - b. Using a 5/16 Allen wrench or hex wrench remove the socket head cap screw, washer and cap from the arbor.
 - c. Remove the blades and rearrange as required.
 - d. Make sure that a grooved blade spacer is reinstalled between each blade. The spacers may stick to the blades but can be pried off easily.
 - e. Be sure to maintain the correct blade rotation direction. Repeatedly reversing the blade rotation will result in premature blade wear.
 - f. Reinstall the cap, washer and socket head cap screw and tighten.

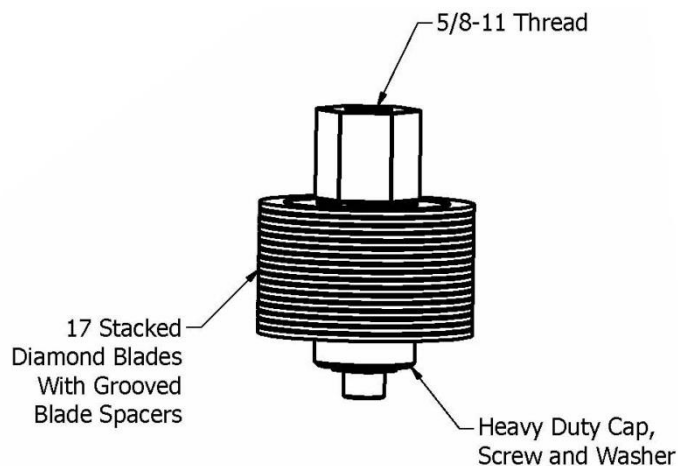

- Center Water Feed Compatible
- Corrossion Resistant Construction

FIGURE 1 - Rapid Z™-CUT (Assembled)

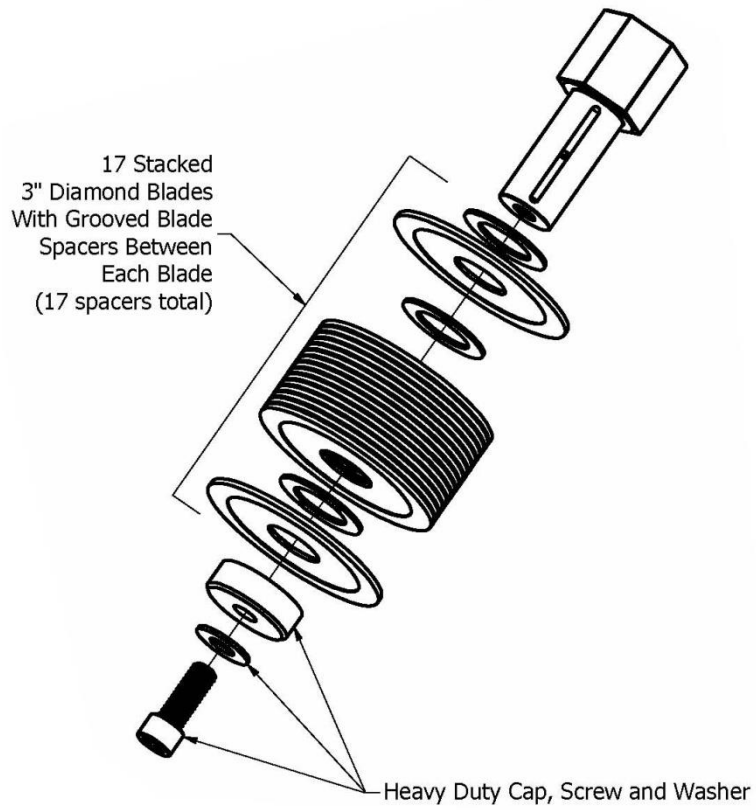

FIGURE 2 - Rapid Z™-CUT (Exploded)

All Rapid Z™ Products are Proudly Designed & Assembled in the U.S.A. from Global Components